



銀中國際電池科技 **23A**

TECHNICAL SPECIFICATION FOR ALKALINE MANGANESE BATTERY

PREPARED BY:

APPROVED BY:

DATE: January 3, 2006

SPEC.NO. : REF----R23----0102

ADD: Room1104 ,Kingsford Industrial Centre,13 Wang Hoi Road, Kowloon Bay,
Kowloon, Hong Kong.
Tel: (852) 22433399 Fax: (852) 23059889
E-mail: sales@xtra-power.com.hk

(Manufacturer reserves the right to alter or amend the design, model and specification without prior notice.)

TECHNICAL SPECIFICATION

REF----R23----0102

1. Other name for the same type

L1028 23L VR22

2. Chemical System

Alkaline Zinc—Manganese battery (+) Zn | KOH | MnO₂ (-)

3. Nominal Voltage: 12V

4. Average Weight: 8.06g

5. Nominal Capacity: 55mAh

(continuous discharge at 20±2°C under 0.10mA discharge current to 7.2V voltage)

6. Appearance: Metal Can

7. Electrical Characteristics:

7.1 Off—load Voltage:

New Battery ≥ 12.10V

After 12 Months (Room Temp.) ≥ 12.00V

7.2 Discharge Time (continuous discharge at 20±2°C under 20K Ω discharge load to 7.2V voltage)

New Battery ≥ 95 hours

After 12 Months (Room Temp.) ≥ 85 hours

7.3 Over—discharge Characteristic

Condition: 20K Ω continuous discharge at 20±2°C & 65±20% R.H.

Period: 48 hours

Characteristic: No deformation is over 0.20mm of the nominal dimension, and no visual electrolyte leakage

8. Dimensions:

Nominal Dimension: $\phi 10.30 \times 28.80$

(Unit: mm)

Dimension	Range
A(ref.)	0.80
B	28.40 ± 0.30
C	10.05 ± 0.15
D(ref.)	0.20

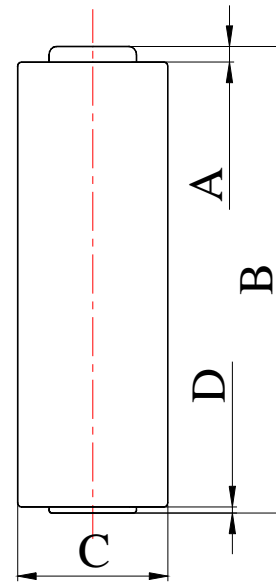

9. Typical Discharge Characteristics

(continuous discharge at $20 \pm 2^\circ\text{C}$ under $20\text{K } \Omega$ discharge load to 7.2V voltage)

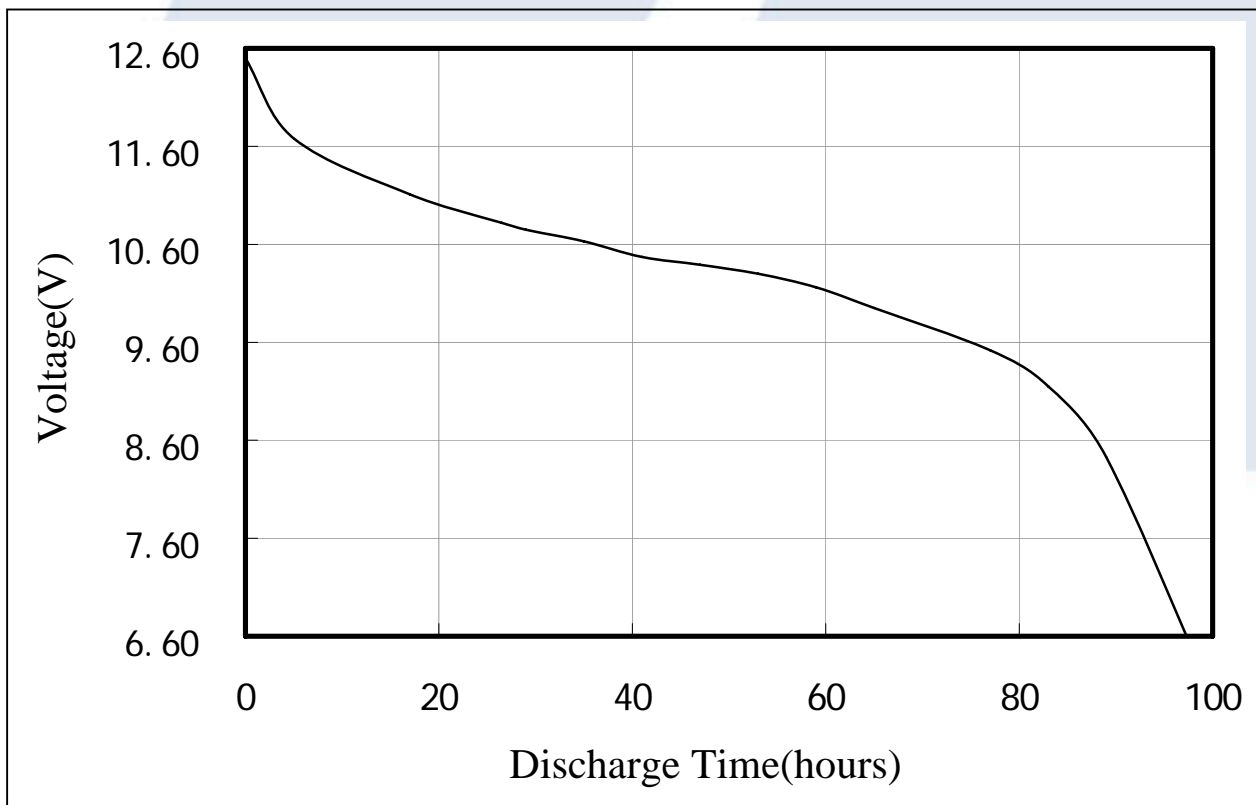

10. Mark:

The following message will be printed or stamped on the body of the battery:

10.1 Designation: 23A、 L1028 etc.

10.2 Manufacturer's name: Strongwill Ultra-Power Battery Technology

10.3 Trademark: Neutral or Xtra-Power

10.4 Nominal Voltage: 12V.

10.5: Pole: “+” and “-”.

10.6 Warning: May explode or leak if charged or disposed of in fire.

11. Caution for use :

11.1 There are risks of electrolyte leakage or causing damage to the device if the battery is charged;

11.2 The battery shall be installed with “+”and “-” in correct position;

11.3 Short-circuiting and heating the battery、 disposing of the can must not be permitted.

—————END—————